



Mobile application

Gespape Mobile also allows to print documents directly from an Android or iOS device (Smartphone / iPhone, Tablet / iPad ...).



Downloading the application

For Android terminals, move to « Play Store » to download « Gespape Mobile » application.

For iOS terminals (iPhone and iPad), move to « App Store » to download « Gespape Mobile » application.

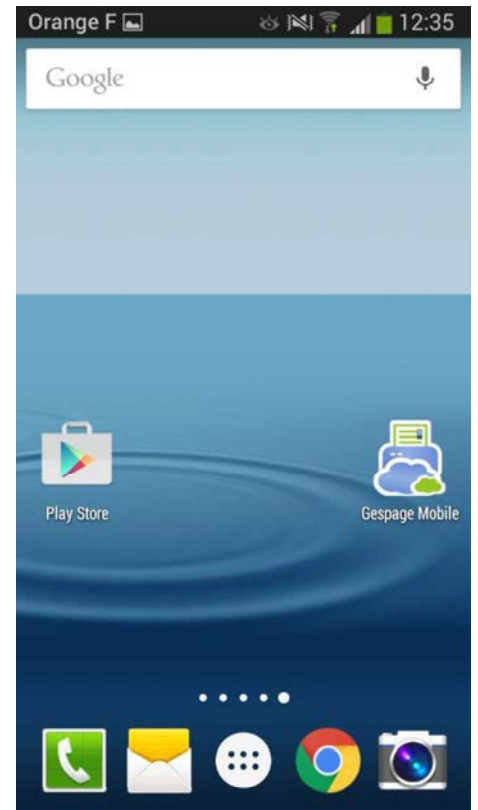

Setting up the application

 A screenshot of the 'Gespape Mobile' app's setup screen. The title bar shows 'Orange F' and the time '12:22'. The screen has a light gray background. At the top left is a hamburger menu icon. The title 'Gespape Mobile' is centered at the top. Below the title is a user profile icon. There are three input fields: 'Location/IP to Gespape' with the value '172.18.224.220' and a circled '1' to its right; 'User name' with the value 'Benutzername' and a circled '2' to its right; and 'Password' with the value 'Passwort' and a circled '3' to its right. At the bottom of the screen is a 'Login' button.

- (1) Fill in the address of Gespape server.
- (2) Indicate your Gespape user name.
- (3) Fill in your password.



Home menu

- (1) Sends the documents to print.
- (2) In front a multifunction or a printer, your documents can be released.
- (3) Displays the details of an account (name, email, credit ...), the history of the operations and the history of the credit.
- (4) Sets up the application.
- (5) Disconnection of the application.



Print

A document may be printed as follows:

- On opening a document compatible with Gespage Mobile.
- Via Gespage Mobile application.

Choice of the document:

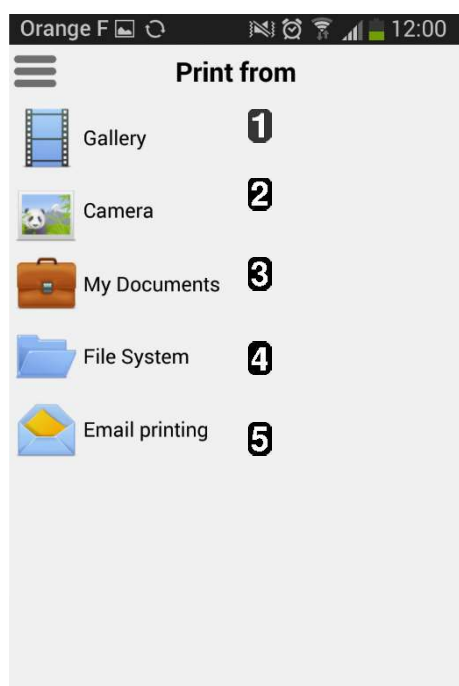

- (1) Prints the photos already taken with your phone.
- (2) Opens the photo application and prints the photo immediately.
- (3) Finds the documents stored on your Gespage personal space to print them.
- (4) Opens the file explorer to print a document present on your phone.
- (5) Information to print by sending an email.

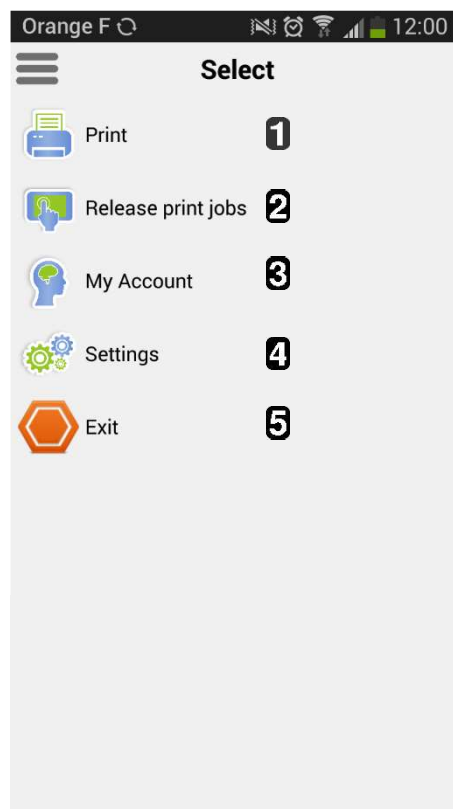

Choice of the printer:

- (1) Fill in the name of the printer of your choice or flash the QR code present on your printer.
- (2) If necessary, change the print settings.
- (3) Release your document to print.

Options of prints

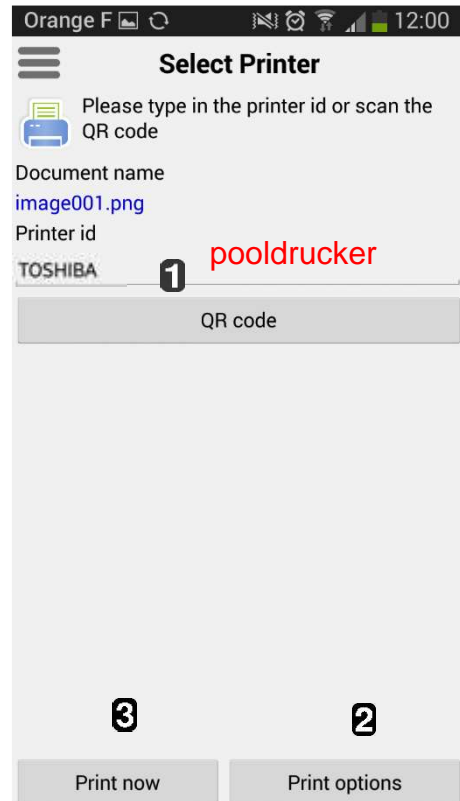
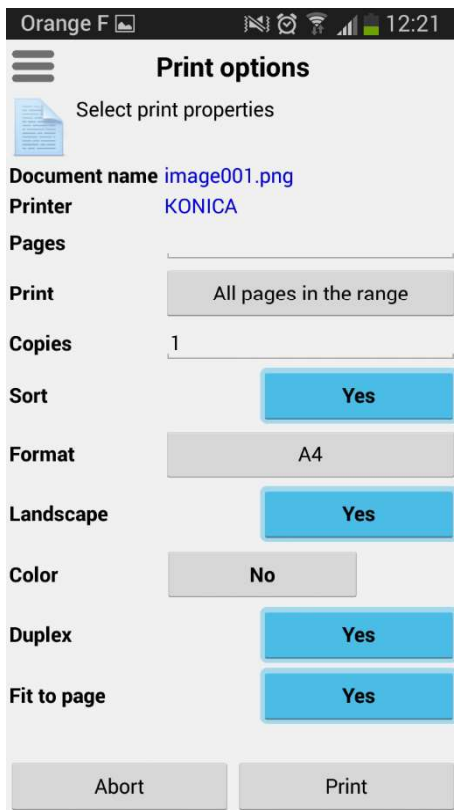



Release the prints

This tab enables a document already sent for printing to be released by choosing the printer.

In front the printer, its name may be filled in **1** or its QR code scanned **2**.

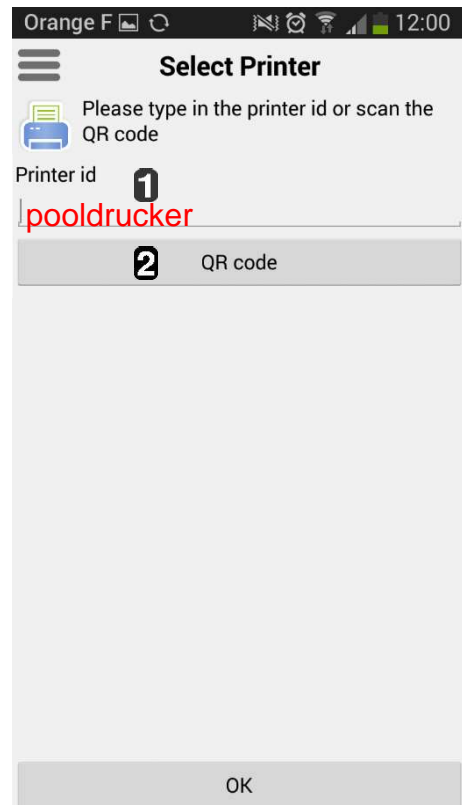

Account management

This menu enables:

- (1)** To consult the account information.
- (2)** To display the history of prints.
- (3)** To consult the history of the credit.

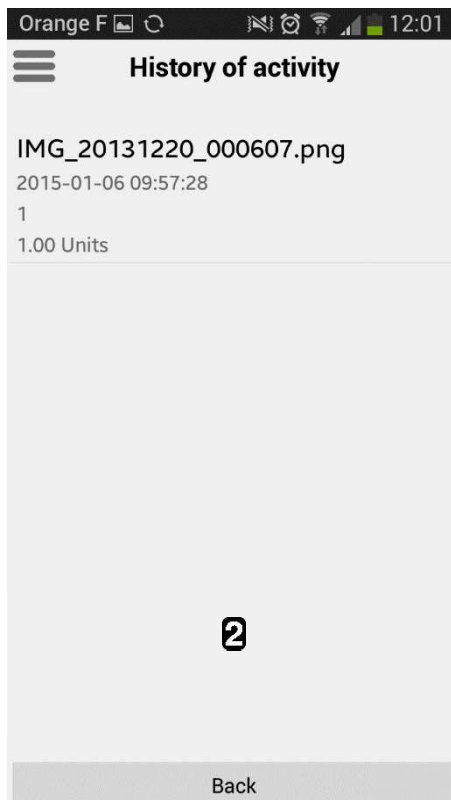
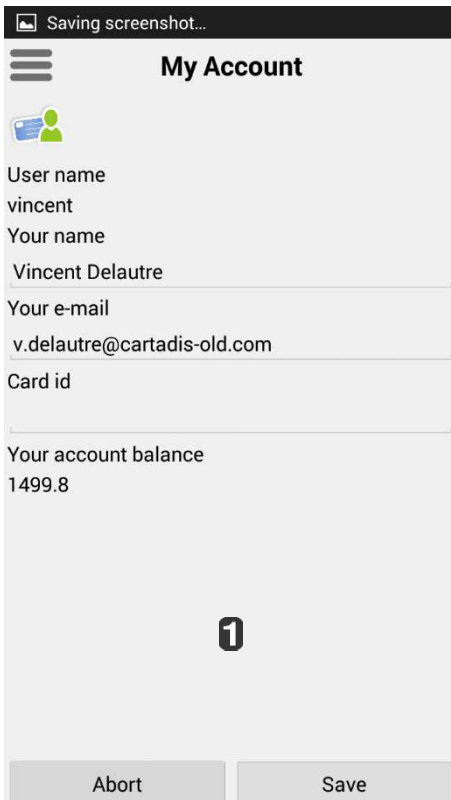



Setting the application

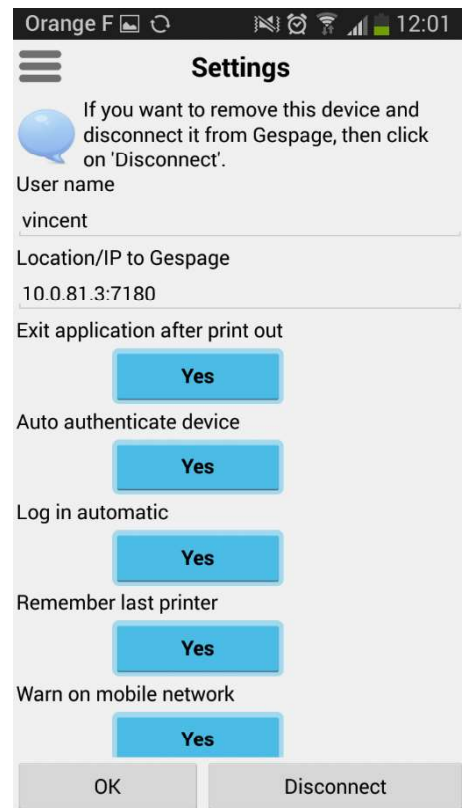

14.2 Web payment user manual

This section deals with the manual for users of the reloading solution of Gespage accounts. A default manual is accessible from the web user interface by clicking  .

It may be customized and modified by moving to the installation directory under GespageCore/Gespage/Geps/geps/etc...

The manual must have the following name:

- Multilingual version: « man.pdf »
- Localized version: « man_locale.pdf » (eg: man_fr.pdf, man_en.pdf).